

526/D2	527/D2	528/D2	529/D2	513/D2	514/D2	515/D2	516/D2	517/D2	518/D2
4+kk	2+kk	2+kk	2+kk	3+kk	2+kk	2+kk	2+kk	2+kk	4+kk
111.4 m <sup>2</sup>	53.4 m <sup>2</sup>	52.7 m <sup>2</sup>	46.5 m <sup>2</sup>	82.2 m <sup>2</sup>	45.8 m <sup>2</sup>	45.8 m <sup>2</sup>	52.7 m <sup>2</sup>	53.4 m <sup>2</sup>	111.7 m <sup>2</sup>



525/D2  
4+kk  
119.2 m<sup>2</sup>

524/D2  
2+kk  
44.3 m<sup>2</sup>

523/D2  
2+kk  
40.1 m<sup>2</sup>

522/D2  
1+kk  
32.9 m<sup>2</sup>

521/D2  
2+kk  
43.5 m<sup>2</sup>

520/D2  
2+kk  
43.5 m<sup>2</sup>

508/D1  
2+kk  
45.9 m<sup>2</sup>

507/D1  
1+kk  
29.9 m<sup>2</sup>

506/D1  
1+kk  
39.7 m<sup>2</sup>

505/D1  
2+kk  
45.1 m<sup>2</sup>

504/D1  
2+kk  
43.2 m<sup>2</sup>

503/D1  
3+kk  
69.9 m<sup>2</sup>

519/D2  
4+kk  
119.5 m<sup>2</sup>

509/D1  
2+kk  
45.5 m<sup>2</sup>

510/D1  
1+kk  
35.7 m<sup>2</sup>

511/D1  
2+kk  
46.0 m<sup>2</sup>

512/D1  
2+kk  
45.4 m<sup>2</sup>

501/D1  
1+kk  
31.8 m<sup>2</sup>

502/D1  
5+kk  
113.5 m<sup>2</sup>

0 20 m



1:350

1+kk 2+kk 3+kk 4+kk 5+kk komory

situace - schéma

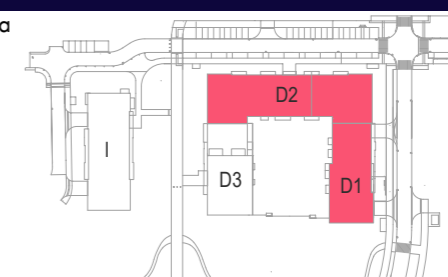

PODLAŽÍ

**5.NP**

INDEX